

# HYDROPOMPE / HYDROPUMP MPV100

## TARIF DES PIECES / PARTS PRICE LIST

CODE	DESIGNATION FRANCAISE	ENGLISH DESIGNATION	PRIX / PRICE
101-M08-020-5-2	VIS H M8X20 GALVA CL8.8	H M8X20 GALVANIZED CL8.8 SCREW	
101-M10-090-2-1	VIS H M10X90 INOX A4-70	H M10X90 STAINLESS A4-70 SCREW	
101-M12-025-2-1	VIS H M12X25 INOX A4-70	H M12X25 STAINLESS A4-70 SCREW	
101-M12-060-2-1	VIS H M12X60 INOX A4-70	H M12X60 STAINLESS A4-70 SCREW	
107-M05-16-2-1	VIS TRCC M5X16 INOX A4-70	STAINLESS SQUARE NECK M5x16 SCREW	
109-3.9-025-2-1	VIS AUTOPERCEUSE M3.9x25	SELF TAPPING M3.9x25 SCREW	
151-M12-160-5-2	VIS H M12X160 CL 8.8 GALVA FP	H M12X160 CL 8.8 GALVA SCREW	
151-M12-200-2-1	VIS H M12X200 INOX A4-70 FP	H M12X200 STAINLESS A4-70 SCREW	
151-M16-130-2-1	VIS H M16X130 INOX A4-70 FP	H M16X130 STAINLESS A4-70 SCREW	
201-M05-0-2-1	ECROU H M5 INOX A4-70	H M5 STAINLESS A4-70 NUT	
201-M08-0-2-1	ECROU H M8 INOX A4-70	H M8 STAINLESS A4-70 NUT	
201-M10-0-2-1	ECROU H M10 INOX A4-70	H M10 STAINLESS A4-70 NUT	
201-M12-0-2-1	ECROU H M12 INOX A4-70	H M12 STAINLESS A4-70 NUT	
201-M16-0-5-2	ECROU H M16 CL 8 GALVA	H M16 CL 8 GALVA NUT	
202-M08-0-2-1	ECROU BAS H M8 INOX A4-70	H M8 STAINLESS A4-70 LOW NUT	
301-08-0-5-2	RONDELLE L8 GALVA	L8 GALVANIZED WASHER	
303-05-0-2-1	RONDELLE M5 INOX A4-70	M5 STAINLESS A4-70 WASHER	
303-08-0-2-1	RONDELLE M8 INOX A4-70	M8 STAINLESS A4-70 WASHER	
303-10-0-2-1	RONDELLE M10 INOX A4-70	M10 STAINLESS A4-70 WASHER	
303-12-0-2-1	RONDELLE M12 INOX A4-70	M12 STAINLESS A4-70 WASHER	
1009	JOINT D'ETANCHEITE DE PISTON	PISTON SEAL	
1012	ECROU FENDU HM12 (STANAL)	HM12 LOCK NUT (STANAL)	
1019	JOINT DE BAUDRUCHE Ø30x2.5	BLADDER O'RING Ø30x2.5	
01024	CORPS INFERIEUR BOITE A CLAPET	VALVE BOX LOWER PART	
1026	CORPS SUPERIEUR BOITE A CLAPET	VALVE BOX UPPER PART	
1027	BILLE PUR Ø25.4	Ø25.4 PU VALVA BALL	
1028	JOINT TORIQUE Ø70 BOITE CLAPET	VALVE BOX O'RING Ø70	
1029	VIS CHC M5x50 INOX A2-70 FP	CHC M5x50 STAINLESS A2-70 SCREW	
1032	ENTRETOISE SEPTOR Ø32 FINE	SEPTOR WASHER Ø32	
1035	SIEGE DE CLAPET D'ASPIRATION	SUCTION VALVE SEAT	
1036	JOINT TORIQUE Ø32 ASPIRATION	SUCTION VALVE O'RING Ø32	
1037	CREPINE D'ASPIRATION	SUCTION STRAINER	
1038	VIS CHC M5x16 INOX A2	CHC M5x16 STAINLESS A2 SCREW	
1040	ECROU HH M14 LAITON	BRASS HH M14 NUT	
1045	COLLIER DOUBLE FIL INOX 31-35	STAINLESS CLAMPING COLLAR	
1052	PLAQUE D'ETANCHEITE FONTAINE	SEALING PLATE	
1056	CADRE A SCELLER	SEALING FRAME	
1151	JOINT PLAT DE BOITE CLAPET	VALVE BOX SEAL	
1178	CYLINDRE DE CORPS DE POMPE	PUMP BODY CYLINDER	
1179	BAUDRUCHE HPV100	HPV100 BLADDER	
1247 / 1486	TUYAU PE100 Ø32x3	Ø32x3 PE100 HOSE	
1275	ECROU POUSSEUR Ø32	Ø32 PUSHER NUT	
1357	JOINT TORIQUE Ø31x4	Ø31x4 O'RING	
1359	GRIFFE DE SERRAGE Ø32	Ø32 CLAMP RING	
1574	TUBE POLYAMIDE 6X8	6X8 POLYAMIDE HOSE	
2336	BUTEE	STOP	
2343	JOINT CALOTTE	CAP SEAL	
2348	RACCORD DROIT F32x1"	F32x1" UNION	
2349	RSE HUOT M32x1"	M32x1" HUOT COUPLING	
2352	PISTON CONIQUE	CONICAL PISTON	
2354	RONDELLE DE BUTEE	STOP WASHER	
2520 / 2521	TUYAU PE100 Ø32x6	Ø32x6 PE100 HOSE	
2610	BATI POUR CADRE A SCELLER	FRAME	
2611	CYLINDRE DE COMMANDE	COMMAND CYLINDER	
2612	DEMI AXE BRAS DE LEVIER	HANDLE HEAD SEMI-AXIS	
2613	TIGE DE PISTON	PISTON ROD	
2614	DEMI AXE DE TIGE DE PISTON	PISTON ROD SEMI-AXIS	
2616	COUVERCLE SUPERIEUR	UPPER COVER	
2617	CAPOT ARRIERE	BACK COVER	
2618	EQUERRE ORIENTABLE LAITON	ROTATING BRASS BRACKET	
2619	TETE DE BRAS	HANDLE HEAD	
2620	BRAS DE LEVIER	HANDLE	
2621	DEVERSOIR	OUTLET	
2622	PLAQUE LATERALE	LATERAL PLATE	
2623	PALIER IGUS	IGUS BEARING SLEEVE	
2624	BUTEE PROGRESSIVE CONIQUE	CONICAL STOP	
2625	ROTULE RADIALE	RADIAL SPHERICAL PLAIN BEARING	
2626	CIRCLIPS Ø47	Ø47 CIRCLIPS	
2627	CORPS DE COLLIER STAUFF 5032-PP	5032-PP STAUFF CLAMP BODY	
2634	PLAQUE DE FIXATION COLLIER STAUFF 5032	5032 STAUFF CLAMP BODY FIXATION PLATE	
2635	BOUCHON DEFLECTEUR	DEFLECTOR PLUG	
2637	BOUCHON DE REAMORÇAGE	PRIMING PLUG	
5040	ECROU H M12 NYLSTOP INOX A2	H M12 STAINLESS A2 NYLSTOP NUT	
6029	RONDELLE M16 INOX A4	M16 STAINLESS A4 WASHER	

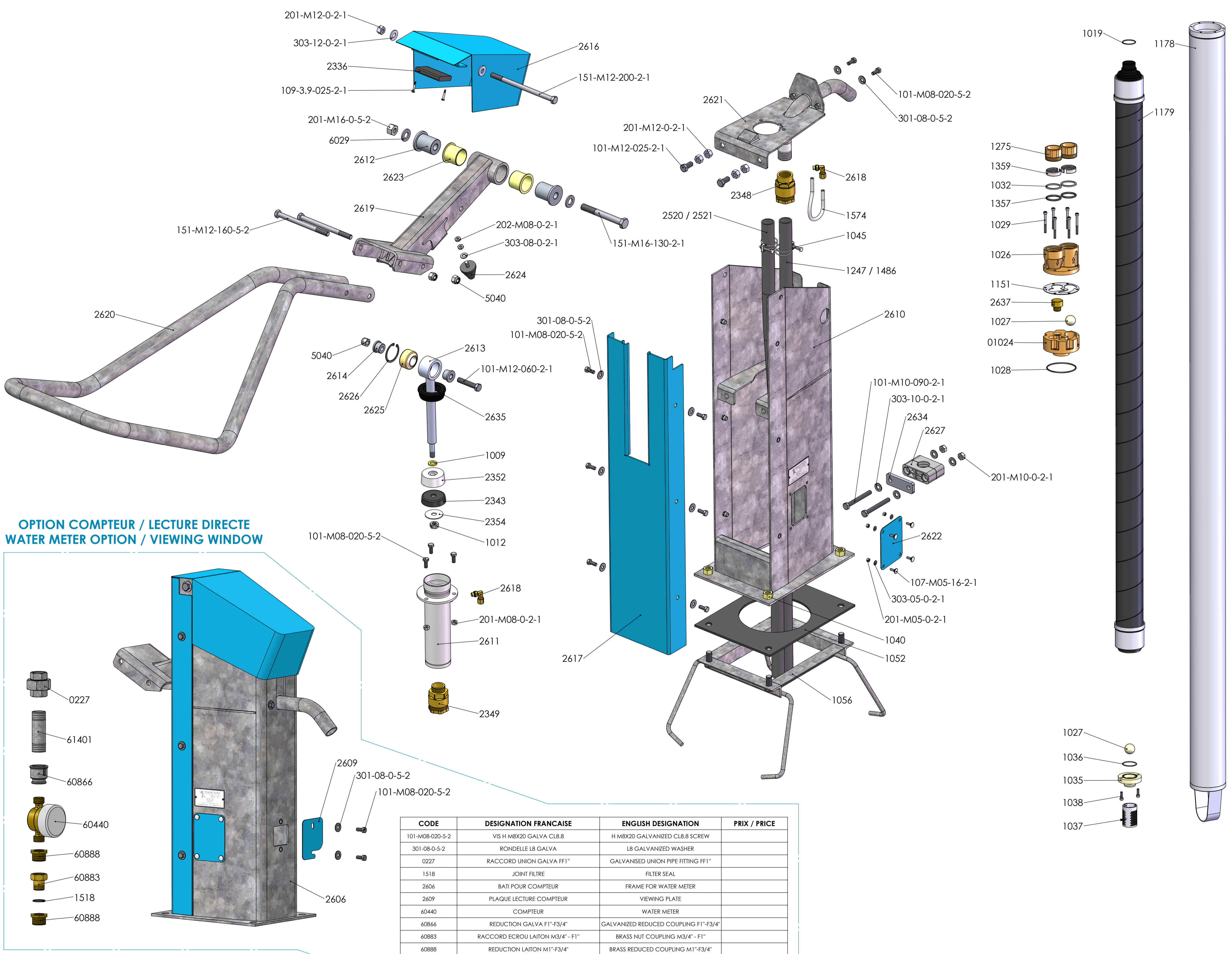

CODE	DESIGNATION FRANCAISE	ENGLISH DESIGNATION	PRIX / PRICE
101-M08-020-5-2	VIS H M8X20 GALVA CL8.8	H M8X20 GALVANIZED CL8.8 SCREW	
301-08-0-5-2	RONDELLE L8 GALVA	L8 GALVANIZED WASHER	
0227	RACCORD UNION GALVA FF1"	GALVANISED UNION PIPE FITTING FF1"	
1518	JOINT FILTRE	FILTER SEAL	
2606	BATI POUR COMPTEUR	FRAME FOR WATER METER	
2609	PLAQUE LECTURE COMPTEUR	VIEWING PLATE	
60440	COMPTEUR	WATER METER	
60866	REDUCTION GALVA F1"-F3/4"	GALVANIZED REDUCED COUPLING F1"-F3/4"	
60883	RACCORD ECROU LAITON M3/4" - F1"	BRASS NUT COUPLING M3/4" - F1"	
60888	REDUCTION LAITON M1"-F3/4"	BRASS REDUCED COUPLING M1"-F3/4"	
61401	ALLONGE GALVA 1" x 100	GALVANIZED TUBE 1" x 100	